

1. Names and Parts

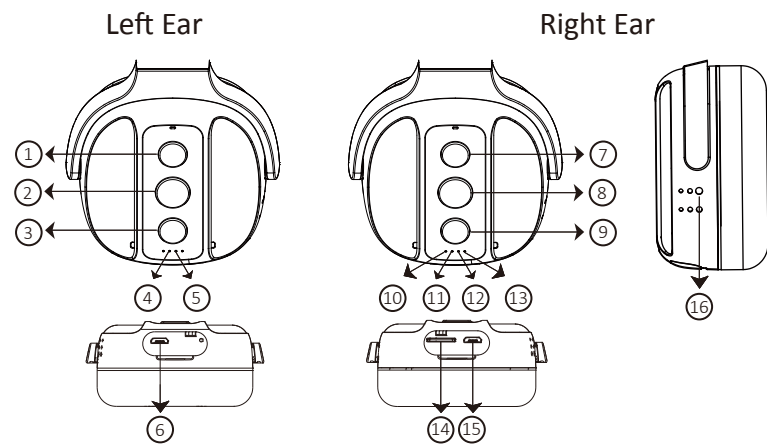

- | | |
|--|--------------------------|
| 1. Previous Track / Volume Up | 9. Format Button |
| 2. MP3 Power On and Off / Play, Pause and Stop | 10. Orange LED (Wi-Fi) |
| 3. Next Track / Volume Down | 11. Blue LED (Power) |
| 4. Blue LED (Power) | 12. Red LED (Record) |
| 5. Red LED (Play/Pause) | 13. Green LED (Charging) |
| 6. USB Port | 14. Memory Card Slot |
| 7. Wi-Fi Button | 15. USB Port |
| 8. DVR Power On and Off / Record and Stop | 16. Lens (Right Ear) |

*Warranty will be void if the serial number sticker is tampered.
*Microphone is not available for USA market.

1

2. Package Content

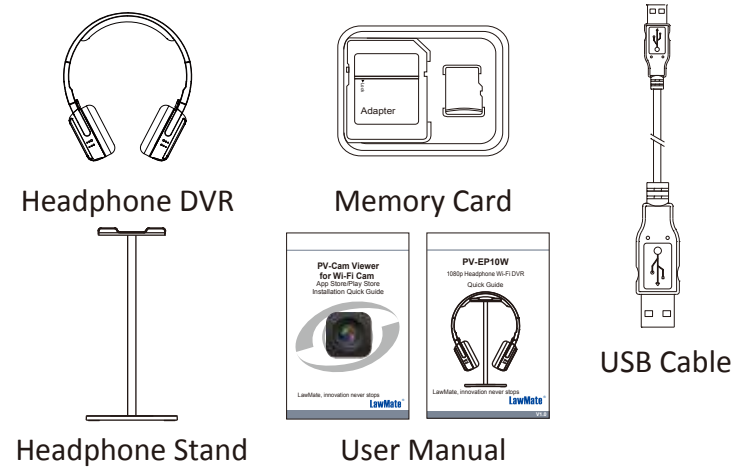

3. LED Indicators

DVR	
Solid Blue LED	Power On
Solid Red LED	Recording On
Solid Orange LED	Wi-Fi On
Solid Green LED	Charging
Headphone	
Solid Blue LED	Power On
Solid Red LED	Playing Tracks
Blinking Red LED	Pause Playing

2

4. Adjust the Headphone

- 4.1 Both sides of the frame are extendable as shown in illustration (A).
4.2 Both ear pads can be turned to 90 degrees as show in illustration (B). Note that the pads can only be turned in the direction shown in the picture, or the pads may be broken.
4.3 You can fold both frames inwards as shown in illustration (C).

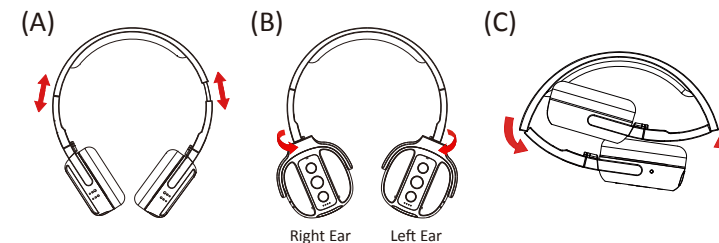

5. Charge the Battery

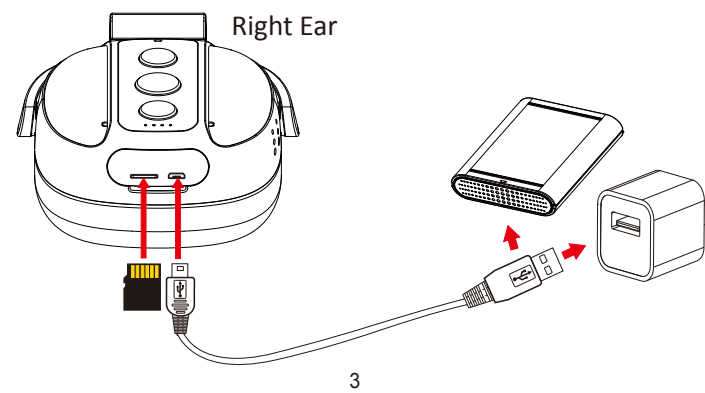

3

Open the flip-up lid on the right-ear side, connect the micro USB end of the cable to the USB port and connect the other end to an USB power source, or plug it to a power bank of your own choice. The power bank then works as an extra battery. When charging is complete, the green LED will go off.

6. Operation

6.1 DVR Function (Right Ear)

6.2.1 Turn On

Long press (8) for 3 seconds. The device vibrates once and the blue LED will go on.

※ Note: Memory card must be inserted to turn on the device, or the device will vibrate once with blue and red LED flickering, then power off automatically.

6.2.2 Record / Stop

To record, short press (8) once. The device vibrates once and the red LED will be solid on while recording.

To stop recording, short press (8) once. No vibration, the red LED goes off.

6.2.3 Wi-Fi

To turn on Wi-Fi function, short press (7) once. The device vibrates once and the orange LED will be solid on. The orange LED flickers when the Wi-Fi is not connected. To turn off Wi-Fi function, short press (7) once. The device vibrates twice and the orange LED will go off. For more Wi-Fi function, please refer to the PV Cam Viewer for Wi-Fi Cam Quick Guide.

4

6.1.4 Turn Off

Long press (8) for 3 seconds. The device vibrates once and all LED go off.

6.2 Headphone Function (Left Ear)

6.2.1 Turn On

Long press (2) for 3 seconds. The blue LED is solid on and red LED flickers, the device is turned on.

6.2.2 Play / Pause

To play the MP3 files, short press (2) once. To pause, short press (2), the red LED flickers. To resume playing, short press (2) again.

6.2.3 Previous / Next Track

Short press (1) to play previous track and short press (3) to play next track.

6.2.4 Volume Up / Down

Long press (1) to turn up the volume and long press (3) to turn down the volume.

6.2.5 Turn Off

To turn off the device, long press (2) for 3 seconds. All LEDs will go off.

6.2.6 Save MP3 Files to Device

To save MP3 tracks in the device, connect the micro USB end of the cable to the USB port (6) and connect the other end to a PC. It will be recognized by PC as an external drive for user to save MP3 tracks in the device.

5

7. Format Memory Card

Press and hold the Format button (9), then long press (8) to turn on the device. The blue LED illuminates and red LED flickers, then the device will power off. The format is completed.

※ Note: It is important to format the card when using it for the first time.

8. Date and Time Setting

Please refer to the **Synchronize the Time** steps on the **PV Cam Viewer for Wi-Fi Cam** Quick Guide.

9. Retrieve Video Files

There are two ways to retrieve video files.

9.1 Use the memory card reader to download video / photo files.

9.2 With the device powered on and memory card inserted, connect the device to PC by USB connection. It will be recognized by PC as an external drive for user to download the video and photo files.

※ Note: The USB port on the left-ear side is only for transferring MP3 tracks.

10. Specification (Headphone)

Audio Spec.	
File Format	MP3 (WAV)
Storage & I/O	
Memory Type	Built-in storage 4GB
Data Interface	MICRO USB 2.0
Power	
Power Input	USB 5V
Power Consumption	18mA-25mA

6

11. Specification (DVR)

Built-in Camera Module	
Built-in Image Sensor	1/3" progressive CMOS sensor
Sensor Resolution	2304x1536
Sensor Sensitivity	3.3 Lux @ F 2.0
Lens F/No.	F 3.2
Focal Length	4mm
Angle of View	66°
Video Spec.	
Algorithm	H.264, JPEG
File Format	MOV, JPG
Video Recording Mode	Manual
Recording Capability	1920x1080
Frame Rate	Up to 30 fps
Photo Capability	5M (2952x1944)
WiFi Spec.	
Wi-Fi	Built-in Wi-Fi Module (IEEE 802.11b/g/n)
Wi-Fi Protocol	RTSP
Storage & I/O	
Memory Type	Memory Card (Support up to 32GB)
Data Interface	Mini USB 2.0
Misc.	
Date/Time Table	YYYY/MM/DD, HH:MM:SS
Snapshot	Recording and playback video (via smartphone)
Power	
Power Input	DC 5V
Power Consumption	340mA-400mA (Wi-Fi OFF) (Wi-Fi ON+80mA)
Charging Time	150 min (580mA*2)
Battery Input	DC 3.7V / 1100 mA high polymers battery(XK503040*2)
Battery Lifetime	Continuous recording 100min(Wi-Fi ON)/120min(Wi-Fi OFF)
Recording time	160min @ 1920x1080 resolution (16GB memory card)
Physical	
Vibration Alert	Power on/off, Recording, Low battery
Dimension	155x178x74.2mm
Weight	190g

7

PV-EP10W 1080P Headphone Wi-Fi DVR Quick Guide

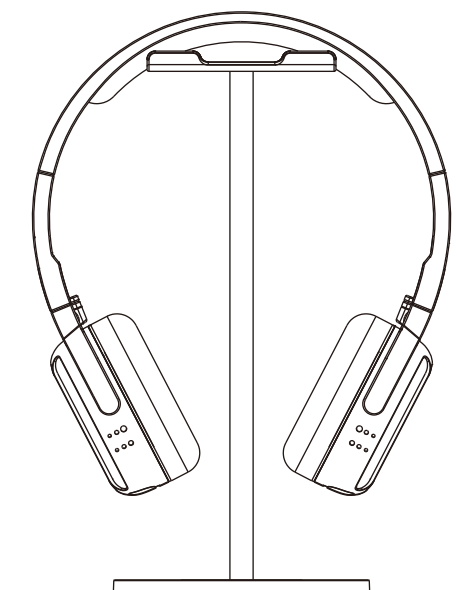

LawMate, innovation never stops

LawMate®

V1.0